

KEY PLAN

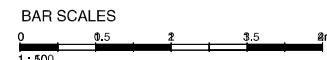
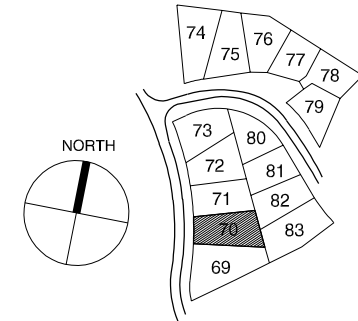

LEGEND

- AR ACRYLIC RENDER COATING ON STYRENE
- EGL EXISTING GROUND LEVEL
- FCC FIBRE CEMENT CLADDING
- FFL FINISHED FLOOR LEVEL
- FGL FINISHED GROUND LEVEL
- FW FLOOR WASTE
- HWU HOT WATER UNIT
- MW METAL CLADDING CORRUGATED COLORBOND
- MR METAL ROOFING CORRUGATED COLORBOND
- RD ROLLER GARAGE DOOR
- R WARDROBE
- RSW RANDOM STONE WALLING
- SL SKYLIGHT
- TB TIMBER BATTENS SEASONED HARDWOOD
- TC TIMBER CLADDING WITH VERTICAL BATTENS
- TD TIMBER DECKING SEASONED HARDWOOD
- CP INDOOR / OUTDOOR CARPET
- CPT CARPET
- CT TILES
- ▨ TIMBER STUD
- ▨ CONCRETE BLOCK
- ▨ RANDOM STONE WALL

Issue	Status	Date
F	APZ added and Studio amended	25.11.04
E	DA SUBMISSION	17.12.03
D	Client Review	28.12.03
C	Client Review	23.10.03
B	Preliminary DA Issue	21.10.03
A	Initial Issue	10.10.03

Consultants

Client:
MARK DARLING

DARYL JACKSON ROBIN DYKE PTY LTD
 64 Rose Street
 Chippendale NSW 2008
 Telephone (02) 9319 2955
 Facsimile (02) 9698 1116
 Email project@djrd.com.au
 Architects

PROJECT
LOT 70
DARLING HOUSE
LAKE CRACKENBACK RESORT

Scale @ A3 Date
 1:100 02.10.03

Description
FIRST FLOOR PLAN

Job Number Dwg. No. Revision
 03 432 A 1.02 F

